

PRODUCT SHEET

Scupper drain for bitumen membrane



Article:	Colour:	In a box:
030-330-345-010	Black	20 pcs.
030-330-345-020	Ivory	20 pcs.
030-330-345-030	Copper	20 pcs.
030-330-345-040	Red	20 pcs.
030-330-345-050	Gold	20 pcs.

Made of special material characterised by high resistance to UV radiation, ozone, and other atmospheric and chemical agents.

Due to refining additives, the drains maintain their flexibility and dimensional stability in a wide temperature range.

Available in several colours so that they can be matched with the façade.

030-330-345-010 - black

030-330-345-020 - ivory

030-330-345-030 - copper

030-330-345-040 - red

030-330-345-050 - gold

Intended for draining roofs and terraces.

When installed horizontally, make sure the drain is pitched at a 3 - 5 degree angle.

Technical drawing

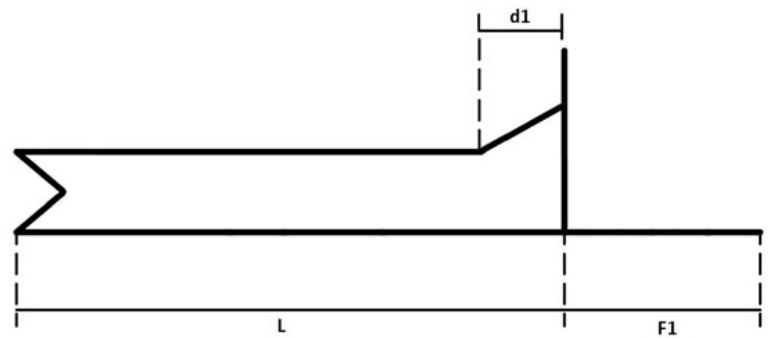
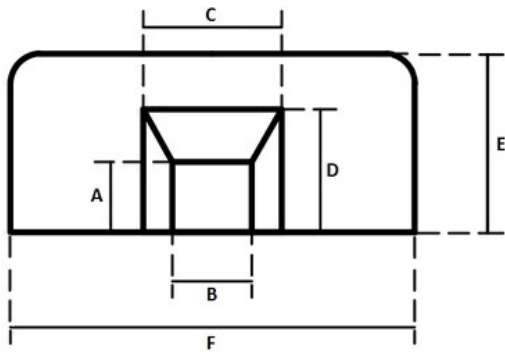

Articles:	A	B	C	D	E	F	F1	L	d1
030-330-34 5-010	48	56	82	80	120	270	120	340	60
030-330-34 5-020	48	56	82	80	120	270	120	340	60
030-330-34 5-030	48	56	82	80	120	270	120	340	60
030-330-34 5-040	48	56	82	80	120	270	120	340	60
030-330-34 5-050	48	56	82	80	120	270	120	340	60

* Wartości w mm